

# High Reliability with Best C/P Value

- For Mission Critical Application in Middle-large Projects

316 HDDs  
JBOD  
Expansion

Up to  
96CH 5MP  
Cameras

Enterprise  
Hardware RAID  
Function

Data Protection  
with  
Spare Drive

**NVR5400 Series**

## Surveon NVR5400 Series

NVR5412/NVR5416 - 96-ch Megapixel Recording

### Features

- Support up to 96 CH megapixel recording (up to 5MP or above) without frame drop
- Support SAS JBOD and iSCSI for storage expansion
- Support maximum total 316 HDDs
- Support hot swappable HDD in 2U 12-bay or 3U 16-bay form factor
- Server-storage design for best cost-performance ratio
- Built-in H/W RAID 1, 5, 6, 1+Spare, 5+Spare, 6+Spare for ultimate data protection
- Support Surveon Enterprise VMS & SurveOne Web-based Easy System Management UI

### Surveon Proven End to End Solutions

Surveon storage-server NVR5400 Series is a Linux-based NVR, offering the best C/P alternative to the current enterprise network video recorder product line. Featuring 12 or 16-bay hot-swappable HDDs and H/W RAID data protection, NVR5400 Series supports 5MP video recording of up to 96 channels and SAS storage with up to 316 HDDs for 1-year plus video retention period, making it ideal for mission-critical projects like city surveillance, industrial and government.



Network Camera



Subsystem Storage



Smart Megapixel NVR



Video Management

### 3rd Party Camera Supported:



and more.

# Surveon NVR5400 Series

## NVR5412/NVR5416 - 96-ch Megapixel Recording

### Technical Specifications

Model		NVR5412E1	NVR5412A1	NVR5416E1	NVR5416A1
System	Main Processor	Intel® Core i3 Dual Core 3.5GHz	Intel® Xeon E3 Quad Core 3.2GHz	Intel® Core i3 Dual Core 3.5GHz	Intel® Xeon E3 Quad Core 3.2GHz
	Operating System	Linux			
Storage	Internal HDD	12		16	
	RAID	RAID 1, 5, 6, 1+Spare, 5+Spare, 6+Spare			
	SAS Expansion	2 x 6G SAS Expansion Port (Optional)			
Video	IP Camera Input	16 / 24 / 32 / 48 / 64 / 96			
	Output	2x HDMI, 1x VGA			
Alarm	Input/Output	8/2			
Display	Resolution	1920 x 1080, 1280x1024, 1280x720, 1024x768			
	Display Split	1 / 4 / 5 / 7 / 9 / 10 / 16 / 32			
Recording	Resolution	5M / 3M / 1080P / 720P / D1			
	Record Rate	960 fps @ 1080P			
	Bit Rate	384Mbps			
	Record Mode	Always, Motion, Event			
Video Detection & Alarm	Video Intelligence	10 Advanced Video Analytics Engines			
Playback & Backup	Playback Channel	16			
	Search Mode	Date / Time, Event, VI			
Network	Ethernet	4 x RJ-45 Port (100/1000)			
General	Power Supply	Input Voltage: 100V~240V			
	Power	Single PSU (500 watts)			
	Working Environment	Humidity: 5% to 80% (non-condensing) Temperature: 5°C to 35°C			
	Dimension	2U 19-inch rackmount with chassis ears: (H)88.00mm x (W)447.40mm x (L)524.41mm		3U 19-inch rackmount with chassis ears: (H)130.00mm x (W)447.40mm x (L)524.20mm	
	Weight	13.60kg/ 29.98lbs (without HDDs)		21.54kg/ 47.49lbs (without HDDs)	

### Surveon NVR5400 Series Feature Highlights

#### • Storage Expandability

Support 14x JBOD 2U 12-Bay (total 180HDDs) / 3U 16-bay (total 240HDDs) / 5x JBOD 4U 60-bay (total 316HDDs) 3 options.

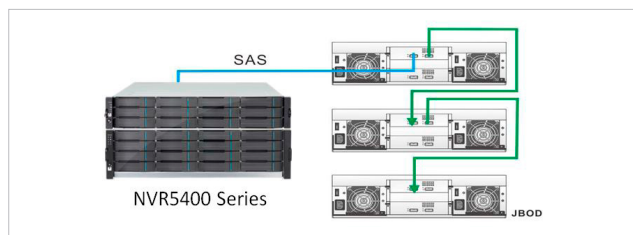

#### • Multi-functional Combination

The Server + Storage design provides high integration with other devices for system stability.



#### • Intelligent Driver Integrity (IDR)

Smart data recovery mechanism to detect and recover bad blocks. Failing drive prediction to copy and clone data before a disk fails.

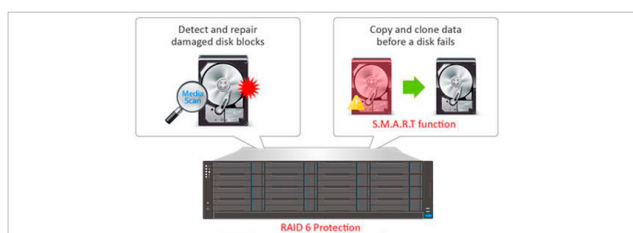

#### • Smooth Performance

Patented read/ write technology to guarantee performance during drive IO delay.



Surveon Headquarters  
10F-3, No.102, Sec. 3, Zhongshan Rd.,  
Jhonghe Dist., New Taipei City 235, Taiwan  
Tel: +886-2-2226-2966  
Fax: +886-2-2226-8278  
Inquiry: sales@surveon.com  
Marketing: marketing@surveon.com  
Technical support: support@surveon.com

USA  
Surveon Corporation  
435 Lakeside Dr. Sunnyvale,  
CA 94085, U.S.A.  
Tel: +1-408-988-5728  
Fax: +1-408-435-5048  
E-mail: sales.us@surveon.com  
Technical support: support.us@surveon.com

Europe (EMEA)  
Surveon Europe Limited  
5 Ringway Centre, Edison Road,  
Basingstoke, Hampshire,  
RG21 6YH, UK  
Tel: +44 (0) 1256 844 566  
E-mail: sales.europe@surveon.com  
Technical support: support.europe@surveon.com

China  
Surveon Technology Inc.  
Room 402-403, Tower D, Yuanyang International  
Center, East Fourth Ring Central Road,  
Chaoyang District, Beijing, China, 100025  
Tel: +86-10-6310-6168  
E-mail: sales.china@surveon.com  
Technical support: support.china@surveon.com